

3

APPLICATION TO ALTER, REPAIR OR DEMOLISH AND FOR A Certificate of Occupancy

CITY OF LOS ANGELES DEPARTMENT OF BUILDING AND SAFETY BUILDING DIVISION

Lot No. Tract Location of Building 3200 Motor Ave. Between what cross streets Manning Ave. and Edith St.

USE INK OR INDELIBLE PENCIL. 1. Present use of building Office Building Families Rooms 4. 2. State how long building has been used for present occupancy 12 years. 3. Use of building AFTER alteration or moving Office Families Rooms 6. 4. Owner Jewish Orphan Home of Southern California. 5. Owner's Address 3200 Motor Ave. 6. Certificated Architect Harman Charles Light. 7. Licensed Engineer. 8. Contractor Chotinar & Gumbiner. 9. Contractor's Address 3123 W. 8th Street.

10. VALUATION OF PROPOSED WORK \$2,500.00. 11. State how many buildings NOW 12 bldg. 1 classrooms, 4 dorms, 1 gym, 1 Rec. Bldg. on lot and give use of each. 12. Size of existing building 28 x 40 Number of stories high 1 Height to highest point 16. 13. Material Exterior Walls Plaster Exterior framework Wood. 14. Describe briefly all proposed construction and work: To alter office partitions and modernize toilet rooms.

NEW CONSTRUCTION. 15. Size of Addition x Size of Lot x Number of Stories when complete. 16. Footing: Width Depth in Ground Width of Wall Size of Floor Joists x. 17. Size of Studs x Material of Floor Size of Rafters x Type of Roofing.

I hereby certify that to the best of my knowledge and belief the above application is correct and that this building or construction work will comply with all laws, and that in the doing of the work authorized thereby I will not employ any person in violation of the Labor Code of the State of California relating to Workmen's Compensation Insurance.

WEST L.A. Signature: [Signature] FOR DEPARTMENT USE ONLY. PLAN CHECKING: Date 10-1-8 1948, Receipt No. 13606, Valuation \$5, Fee Paid \$. REINFORCED CONCRETE: Bldg. Cement, Tons of Reinforcing Steel. FEES: Bldg. Per \$10.00, Cert. of Occupancy \$10.00, Total \$20.00. TYPE GROUP: I-4. PERMITS: 27148. PLANS: [Signatures].

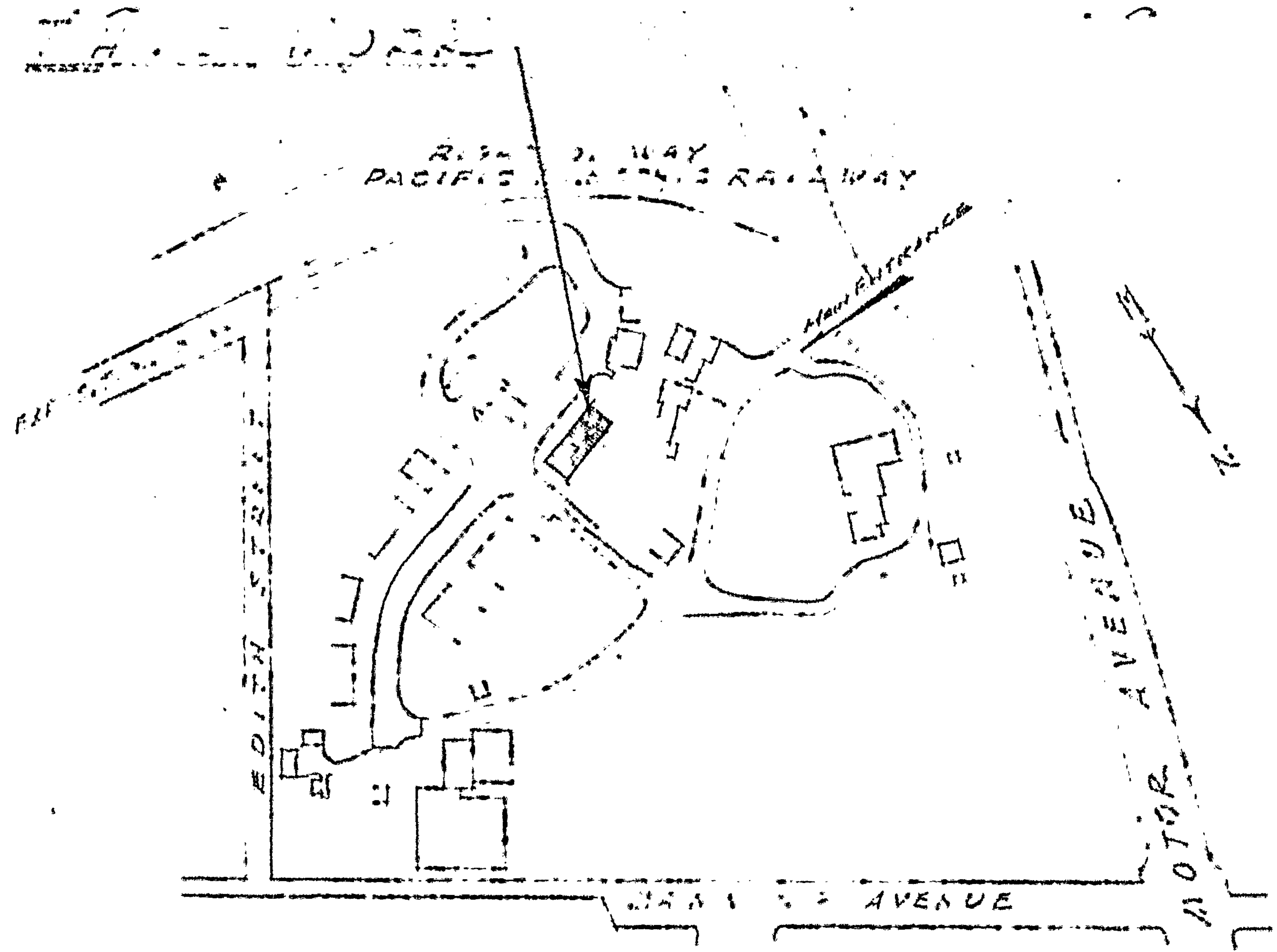

GENERAL PLAN PLAN
SCALE: 1" = 200'