

MAR VISTA ADDITION

By an election held September 22, 1926, Ord. No. 50140, approving the election adopted Oct. 1, 1926, and notice filed with the Secretary of State March 5, 1927, the following described territory was annexed:

Beginning at the point of intersection of the southwesterly line of Overland Avenue with the southeasterly line of the right-of-way of the Pacific Electric Railway Company, Venice Short Line, said point being also the point of intersection of the southwesterly boundary of the City of Los Angeles with the northwesterly boundary of Culver City as said boundary existed June 15, 1926; thence southwesterly along the boundary of Culver City as said boundary existed June 15, 1926, and continuing along said last mentioned boundary in all its various courses and curves to a point in the boundary of the City of Los Angeles as said last mentioned boundary existed on said date, said last mentioned point being also the point of intersection of the northwesterly prolongation of the northeasterly line of Santa Monica Avenue as shown on map of Tract No. 5951, recorded in Book 77, page 72, of Maps, Records of Los Angeles County, with the northwesterly line of Zanja Street; thence northeasterly along said boundary of the City of Los Angeles and continuing along said last mentioned boundary in all its various courses to the most easterly corner of the City of Santa Monica as said City of Santa Monica existed June 15, 1926, said last mentioned corner being also a point in the southwesterly line of Centinela Avenue; thence northwesterly along the boundary of the City of Santa Monica in all its various curves and courses to a point in the boundary of the City of Los Angeles, said last mentioned point being a point in Pico Boulevard and the most southerly corner of the former City of Sawtelle; thence northeasterly along the boundary of the City of Los Angeles as said boundary existed June 15, 1926, and continuing along said last mentioned boundary in all its various courses and curves to the point of beginning, all in the County of Los Angeles, State of California.

~~Barnes City Consolidation~~

~~By an election held Sept. 14, 1926, Ord. No. 56497, approving the consolidation adopted Nov. 18, 1926, and notice filed with the Sec. of State, April 11, 1927, the following described territory was consolidated with the City of Los Angeles:~~

~~For Description see Barnes City.~~

TRACT NO 8395
 MR. J. B. 95-4-5
 GEORGE TR. M.S. 16 61
 AMORIS MAGRADO
 C.F. 64
 ROSSELLIZ MAGRADO
 H.W. CRIPS
 TRACT NO 8340
 C.F. 53
 JAMES T. CRIPS
 LOTMENT

JOHN DAY
 R.F. 52
 JOHN D. YOUNG
 R.F. 580
 LOT 1

JOHN D. YOUNG
 R.F. 580
 LOT 2

NEWMARK
 & EDWARDS
 SUBDIVISION
 M.S. 70-639

TOMASA & TALAMANTES
 JACINTO & TALAMANTES
 PARTITION OF PEDRO TALAMANTES
 LOTMENT
 LOTMENT

MAP
 SHOWING THE PROPOSED
MAP VISTA ADDITION
 CITY OF LOS ANGELES
 City Engineer June 1922
 Scale 1/2" = 100'

Reference to Plat No. 55661
 Exhibit 22
 Division of Assessor's Office
 City of Los Angeles

CITY OF LOS ANGELES
 SEALS

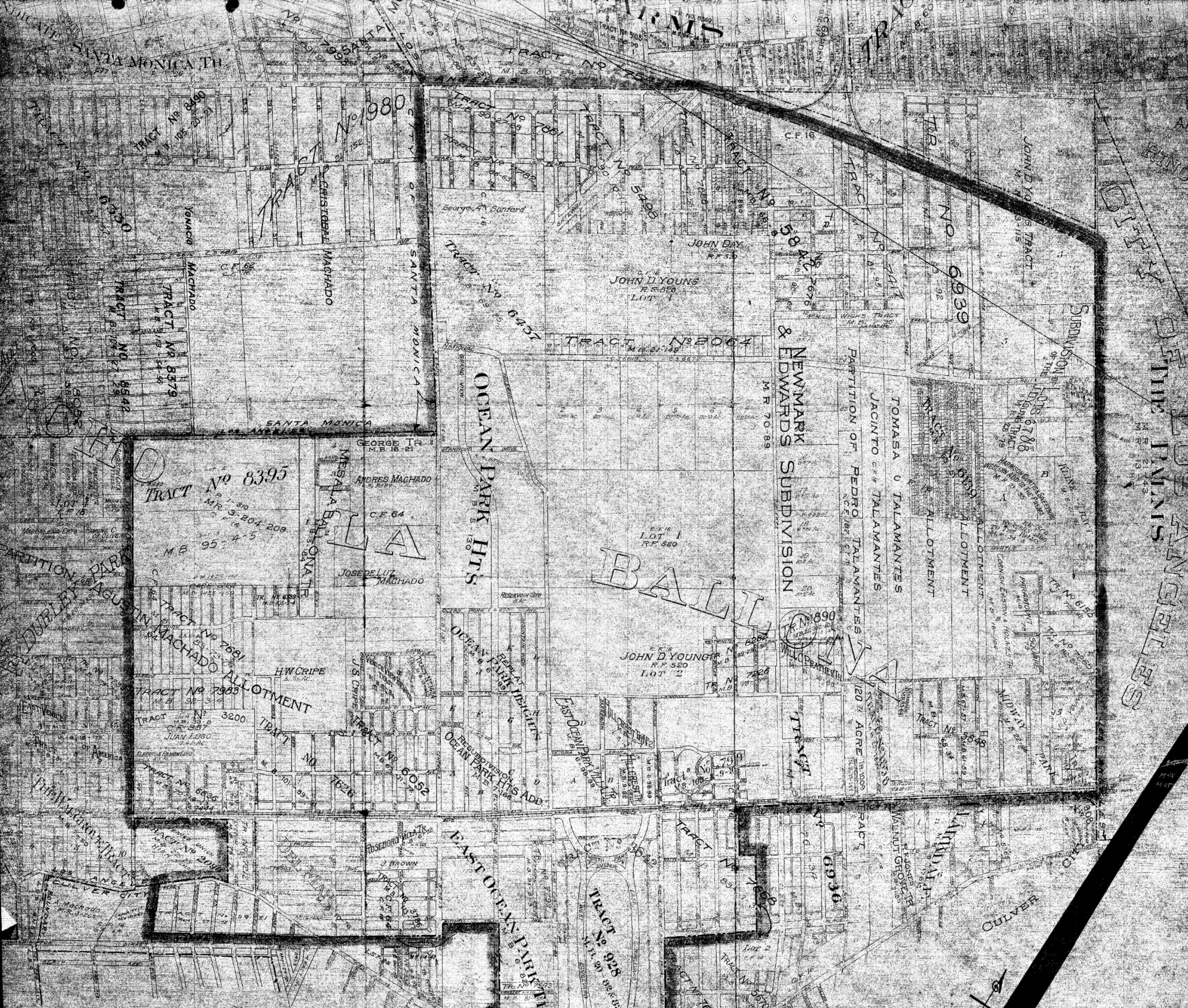

MAP

SHOWING THE PROPOSED
MAR VISTA ADDITION
 CITY OF LOS ANGELES

John C. Shaw, City Engineer June 1926

Scale 1" = 600' Area 3190 AC. ± 4.98 sq. M.

Ordinance calling Election No. 55661

Election held Sept. 22, 1926

Ordinance of Acceptance No.